



PUMPMASTER
AUSTRALIA

THE LONG HOT

Samurai Summer

PROMOTION



KOSHIN LTD.

KOSHINPUMP.COM

MADE IN JAPAN



High pressure pumps suitable for firefighting along with other general applications, like water transfer and small irrigation.



SERM50V

The ultimate super-high pressure firefighting pump, unmatched for multiple purpose use.

High pressure for fires and huge flows for water transfer.

2" (50mm) suction & discharge. Plus 2 x 1" (25mm) outlets.

Powered by a unique heavy duty Mitsubishi motor designed by Fuji Heavy Industries Japan, specifically for this pump.

The superb quality of this machine ensures a long product life, fitted with replaceable diffuser wear ring to maintain "as new" performance. Comes as standard in robust CPTE roll frame.

This is the pump for those who are serious about fighting fires.



LTF40C & LTF40C-2*

1 1/2" (1" x 1") x 1 1/2" single or twin impeller pumps for general farm use.

All metal construction & rapid self priming make this pump reliable and easy to use.

Fitted with replaceable cast iron suction & delivery ports.

Available with standard engine fuel tank or long range 13L tank for extended run times.

All units are fitted with roll frames and come with 2 year warranty.

LTF40C with 13L Tank*

LTF40C & LTF40C-2 (as above) fitted with long range fuel tank for those applications where longer run times are needed. This 13L tank will provide approx. 8hrs of use which is ample for most jobs.



* Units not made by Koshin.

MODEL		LTF40C	LTF40C-2	SERM50V
PUMP	Connection Dia.	40mm	40mm	50mm
	Connection Thrd.	Outer Pipe Thread (BSP)		
	Total Head	60m (196ft)	76m (249ft)	90m (295ft)
	Delivery Volume	445L/min	280L/min	500L/min
	Max. Suction Head	8m (26ft)		
	Mech. Seal	Carbon Ceramic		Silicon Carbide
	Impeller	Die Cast Aluminum		FC
	Volute	Cast Iron		FC
	Type	Forced Air Cooling 4 Stroke Petrol Engine		
	Model	Honda GX160	Honda GX160	Mitsubishi GM182 Hi-R
ENGINE	Capacity	163cc	163cc	181cc
	Rated Output	2.9kW (3.9PS)/3600 rpm	2.9kW (3.9PS)/3600 rpm	3.3kW (4.5PS)/3600rpm
	Max. Output	3.6kW (4.9PS)/3600 rpm	3.6kW (4.9PS)/3600 rpm	4.4kW (6.0PS)/3600rpm
	Fuel	Automotive Unleaded Petrol		
	Fuel Tank Capacity	3.1 L	3.1 L	3.8 L
	Cont. Duty	Approx. 2hr 10min	Approx. 2hr 10min	Approx. 2hr
	Starter	Recoil Starter		
	Gross Weight	29 kg	31 kg	34 kg
	L x W x H (mm)	500 x 420 x 460		565 x 460 x 483
	Dimensions Long Range	580 x 500 x 560		

Performance Curves

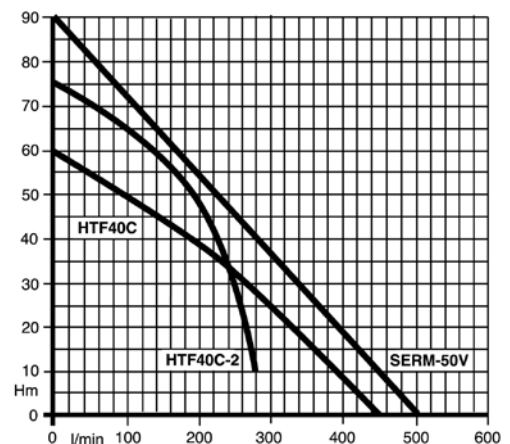



PGH50GX

The only pump that can do it all.

This pump is great for pumping general farming liquid fertilizer, herbicides and pesticides, sea water for fish farming, brine for preserving foods, irrigation and water transfer. Pump casing, impeller and volute are all made from superior Polyethylene Terephthalate giving this pump outstanding corrosion resistance and strength.

As long as the liquid being pumped is no heavier than water (same viscosity) then this pump is the one you need. (Note EPDM elastomers in this pump are not suitable for diesel fuel) 2" suction and discharge. (female 50mm BSP).

With its compact design and pumping versatility this is an excellent all round pump.



SEH50T & SEH80T

These 2" & 3" Semi Trash pumps are the optimal choice for pumping water with some "light rubbish" that would otherwise clog a conventional transfer pump.

Simple quick to remove bodies to speed up cleaning and reduce down time. Fitted with Silicon Carbide mechanical seals and spheroidal graphite iron impellers and volutes for 10 times more abrasion resistance than standard materials. Can handle solids up to 8mm particle size.

The pump of choice for those who need to pump from dams and creeks with sandy or muddy water.



SEM25L

SEH25L

The ever popular 1" x 1" pump available with either 2 stroke Mitsubishi or 4 stroke Honda motors. High quality light weight construction, suitable for pumping water and diesel fuel.



MODEL	PGH50GX	SEH25L	SEM25L	SEH50T	SEH80T
Connection Dia.	50mm	25mm	25mm	50mm	80mm
Connection Thrd.	Inner Pipe Thd.	Outer Pipe Thread (BSP)			
Total Head	26m (86ft)	35m (114ft)	35m (114ft)	30m (98ft)	25m (82ft)
Delivery Volume	600L/min	115L/min	115L/min	600L/min	910L/min
Max. Suction Head	8m (26ft)				
Mech. Seal	Carbon Ceramic			Silicone Carbide	
Impeller	PET + GF	ADC		Hi-Chrome	
Volute	PET + GF30	ADC		Spheroidal Graphite Iron Castings	
Type	4 Stroke Honda			4 Stroke Honda	
Model	Honda GX120	Honda GX25	Mitsubishi TU26	Honda GX120	Honda GX160
Capacity	118cc	25cc	25.6cc	118cc	163cc
Rated Output	2.1kW/3600rpm	.81kW/7000rpm	1.03kW/7500rpm	2.1kW/3600rpm	3.6kW/3600 rpm
Max. Output	2.9kW/4000rpm	.81kW/7000rpm	1.03kW/7500rpm	2.9kW/4000rpm	2.9kW/3600 rpm
Fuel	Unleaded Petrol		2 Stroke Mix	Unleaded Petrol	
Fuel Tank Capacity	2.5 L	0.55 L	0.6 L	2.5 L	3.1 L
Cont. Duty	Approx. 2.5 hrs	Approx. 1hr	Approx. 1hr	Approx. 2.5 hrs	Approx. 2hrs
Starter	Recoil Starter				
Standard Accessories					
Gross Weight	22 kg	7 kg	6 kg	25 kg	35 kg
L x W x H (mm)	540 x 418 x 433	375 x 235 x 350	345 x 260 x 345	493 x 377 x 420	530 x 423 x 488

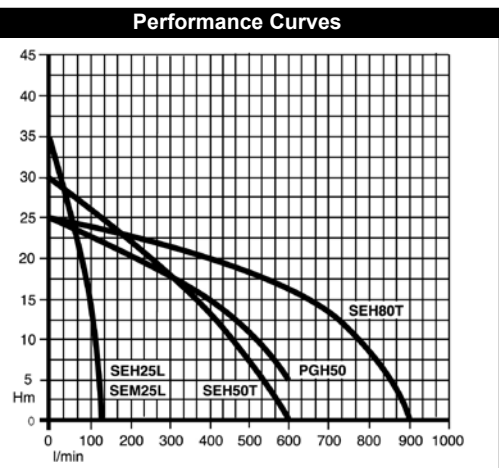

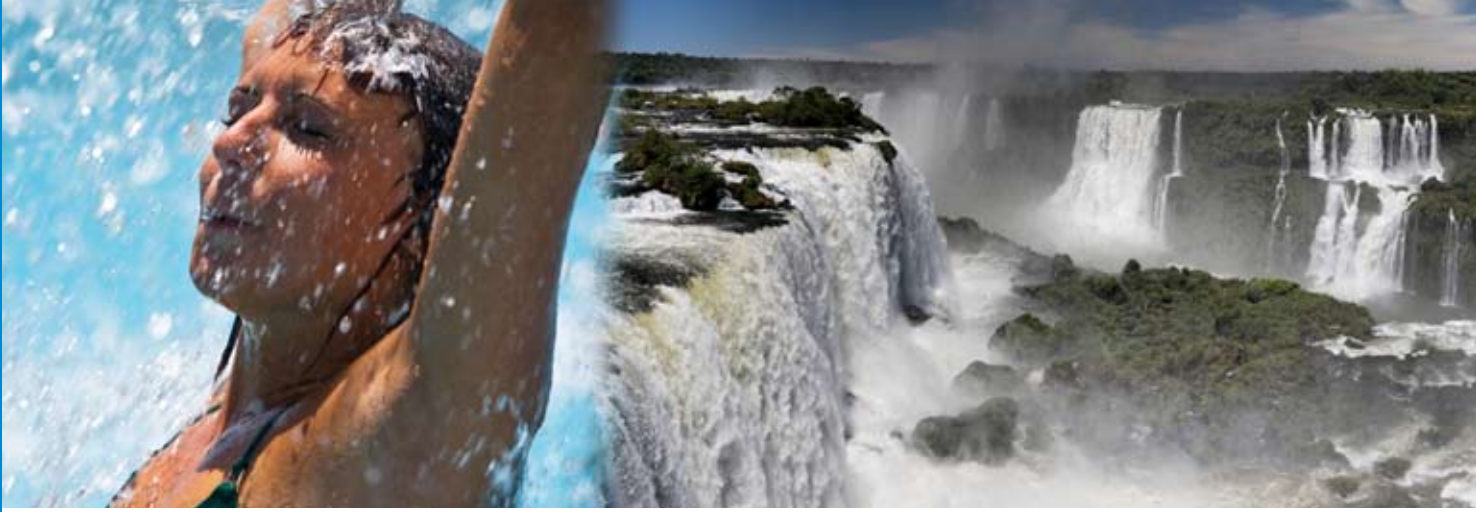

SEH50X, SEH80X & SEH100X



2", 3" & 4" water transfer pumps to cover you from the small jobs to the large. High flows and very solid construction coupled with Japanese built Honda motors make this a very popular pump for general water transfer. Highly effective mechanical seal made with special carbon ceramics provides extra durability, entire unit is protected by sturdy powder coated roll frame.



**** Available soon. Complete with Robin Diesel Motors (Electric Start)**

SER80XD

This is the ideal pump for low pressure irrigation, pumping from dams or rivers, water transfer, filling tankers, etc....

Powered by the renowned Robin air cooled diesel engine. The high quality engine and pump componentry ensure a long working life with the economy of a diesel motor. Fitted with strong anti-vibration mounts and mounted inside a robust steel frame, for protection against handling damage.

3" suction and delivery ports in BSP thread.



MODEL		SEH50X	SEH80X	SEH100X	SEH80XD	Performance Curves
PUMP	Connection Dia.	50mm	80mm	100mm	80mm	
	Connection Thrd.	Outer Pipe Thread (BSP)				
	Total Head	30m (98ft)	26m (85ft)	27m (88ft)	26m (85ft)	
	Delivery Volume	600L/min	950L/min	1450L/min	950L/min	
	Max. Suction Head	8m (26ft)				
	Mech. Seal	Carbon Ceramic				
	Impeller	FC				
Volute	FC-20					
ENGINE	Type	Air Cooling 4 Stroke Petrol			Diesel	
	Model	Honda GX120	Honda GX160	Honda GX240	Robin DY23-2D	
	Capacity	118cc	163cc	242cc	230cc	
	Rated Output	2.1kW/3600rpm	3.6kW/3600 rpm	4.4kW /3600 rpm	3.1kW/3600rpm	
	Max. Output	2.9kW/4000rpm	2.9kW/3600 rpm	5.3kW /3600 rpm	3.7kW/3600rpm	
	Fuel	Automotive Unleaded Petrol			Diesel	
	Fuel Tank Capacity	2.5 L	3.1 L	5.3 L	3.2 L	
	Cont. Duty	Approx. 2.5 hrs	Approx. 2hrs	Approx. 2.5 hrs	Approx. 3hr	
	Starter	Recoil Starter				
	Standard Accessories	1 Strainer, 2 Hose Couplings, 3 Hose Clamps, 1 Engine Tool				
Gross Weight	22 kg	34 kg	59 kg	50 kg		
L x W x H (mm)	493 x 377 x 415	530 x 399 x 473	680 x 487 x 684	583 x 423 x 515		



KTH50X & KTH80X

2" & 3" trash pumps for pumping water with some solids and trash like materials (ie weed, alge, sticks, leaves, mud and other items that would destroy a normal pump).

2" & 3" pumps can handle solids up to 20mm & 27mm in diameter respectively, making them very versatile machines. These pumps all have excellent self priming capabilities.

With quick release front bodies for fast cleaning, silicon carbide mech seals Hi-chrome impellers and FCD castings for long working life, this pump will not let you down.



KTH100X

The serious pump for serious people, when no mucking around will be tolerated and significant water and solids have to be moved quickly.

This 4" Trash pump can shift solids up to 27mm in diameter plus 1600L/min.

With quick release front bodies for fast cleaning, silicon carbide mech seals Hi-chrome impellers and FCD castings for long working life, this pump will not let you down.



MODEL	KTH-50X	KTH-80X	KTH-100X
Connection Dia.	50mm	80mm	100mm
Connection Thrd.	Outer Pipe Thread (BSP)		
Total Head	30m (98ft)	27m (89ft)	25m (82ft)
Delivery Volume	700L/min	1340L/min	1600L/min
Max. Suction Head	8m (26ft)		
Mech. Seal	SiC (Silicon Carbide) x SiC		
Impeller	Hi - Chrome		
Volute	Spheroidal Graphite Iron Castings		
Type	Forced Air Cooling 4 Stroke Petrol Engine		
Model	Honda GX160	Honda GX240	Honda GX340
Capacity	163cc	242cc	337cc
Rated Output	2.9kW (3.9PS)/3600 rpm	4.4kW (6.0PS)/3600 rpm	5.8kW (7.9PS)/3600 rpm
Max. Output	3.6kW (4.9PS)/3600 rpm	5.3kW (7.2PS)/3600 rpm	7.1kW (9.7PS)/3600 rpm
Fuel	Automotive Unleaded Petrol		
Fuel Tank Capacity	3.1 L	5.3 L	6.1 L
Cont. Duty	Approx. 2hr 10min	Approx. 2hr 30min	Approx. 2hr
Starter	Recoil Starter		
Standard Accessories	1 Strainer, 2 Hose Couplings, 3 Hose Clamps, 1 Engine Tool		
Gross Weight	51 kg	63 kg	85 kg
L x W x H (mm)	656 x 498 x 524	721 x 516 x 586	790 x 580 x 675

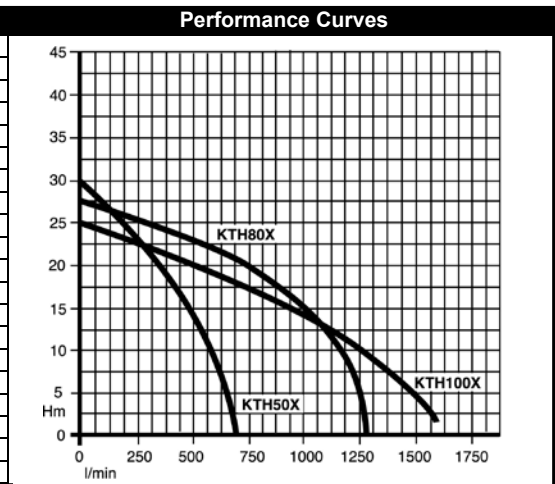

TRASHMATE



SU-40V, SU-50V & SU-80V

Available in 3 different sizes for different applications 40mm (1.1/2”), 50mm (2”) and 80mm (3”), featuring large flows at medium to high heads. These pumps are ideal for supplying water for general irrigation and sprinkler systems.

These high quality pumps can be coupled by v-pulleys, to a wide variety of power sources including electric and hydraulic motors, petrol and diesel engines.

Pump casing is made from die cast aluminum, impeller and volute from graphite iron castings for extra strength plus greater abrasion resistance whilst keep weight low. New 6 bladed impeller for better efficiency and more effective mechanical seal design for longer life.

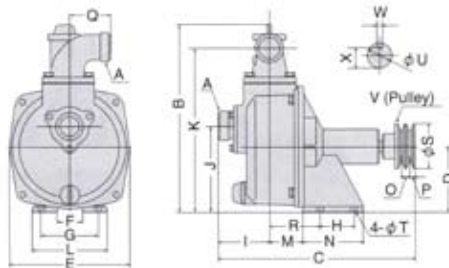
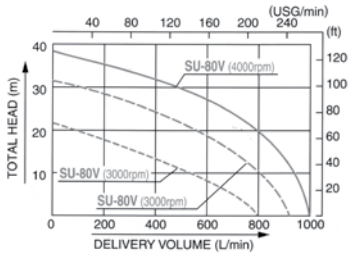
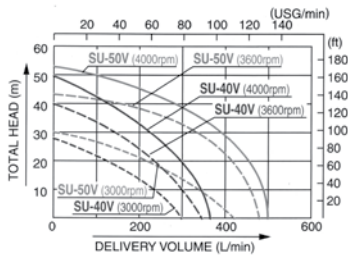

Model	A	B	C	D	E	G	H	I	J	K	L
SU-25	PS1*	273	260	90	174	130	45	92	121	242	150
SUR-25V	PS1*	319	330	110	209	150	60	86	147	280	190
SU-40(V)	PS1½*	319	341	110	209	150	60	91	147	280	190
SU-50H	PS2*	327	371	115	238	175	80	100	152	287	205
SU-50V	PS2*	378	371	115	238	150	80	100	152	337	205
SU-80L	PS3*	428	404	130	270	205	85	122	175	371	235

M	N	O	P	Q	R	S	T	U	V (Pulley)
41	90	15	90	56	71	64	9	19	5 2½"xA2
52	108	15	108	60	85	64	11	19	5 2½"xA2
52	108	15	108	75	85	78	11	19	5 3"xA2
56	127	19	127	76	88	78	11	24	7 3"xB2
56	127	19	127	80	88	78	11	24	7 3"xB2
72	130	19	130	112	102	78	14	24	7 3"xB2

MODEL	SU-40V			SU-50V			SU-80V		
Connection Dia.	40mm			50mm			80mm		
Connection Thrd.	Outer Pipe Thread (BSP)								
Revolution	3000rpm	3600rpm	4000rpm	3000rpm	3600rpm	4000rpm	3000rpm	3600rpm	4000rpm
Total Head	28m (91 ft)	40m (131 ft)	50m (164 ft)	30m (98 ft)	42m (137 ft)	53m (173 ft)	21m (68 ft)	31m (101 ft)	38m (124 ft)
Delivery Volume	300 l/min	350L/min	370L/min	430L/min	480L/min	500L/min	800L/min	920L/min	1000L/min
Max. Suction Head	7m (23ft)	8m (26ft)		7m (23ft)	8m (26ft)		7m (23ft)	8m (26ft)	
Output	1.5 kW	2.2 kW	3.7 kW	2.2 kW	3.7 kW	5.5 kW	3.7 kW	5.5 kW	7.5 kW
Standard Accessories	1 x Strainer, 2 x Couplings, 3 x Hose Clamps								
Gross Weight	13 kg			16 kg			22kg		
L x W x H (mm)	370 x 222 x 255			402 x 260 x 295			444 x 287 x 393		



These select few products have been carefully chosen to be incorporated into Pumpmaster's impressive range of engine driven pumps. These units will be released over the next few months and of course they will count towards your free trip to Japan.



SMD-50 & SMD-80*

2" & 3" DIAPHRAGM PUMPS

Removes rainwater ponding at construction sites. Cleans out septic tanks, pumps waste water and more! Extra-low vibration and noise levels. 163cc Honda GX-160 overhead valve engine delivers dependable, efficient power. Heavy duty cast aluminum pump body and gear case make transportation easier.

Rubber diaphragm and check valve are replaceable. Grease-filled gear unit is maintenance-free.

Safley pump Sand, Mud, Sludge and Muck with out damaging your pump.

PCH-2700, PCH-3000 & PCH3600*

This range of three machines in 2700, 3000 & 3600psi will provide you with all the pressure you'll need.

Comes with high pressure hose and quick couplings, suction hose and detergent hose, 5 colour coded nozzels to suit lance quick connector and intergrated detergent feed. Powder coated frame with pneumatic tyres and fold down handle.

Industrial grade pumps with ceramic pistons and solid brass pump housing provides quality and performance every time.



* Units not made by Koshin.

MODEL		SMD-50	SMD-80	PCH-2700	PCH-3000	PCH-3600	Performance Curves (70strokes/min)	
PUMP	Connection Dia.	50mm	80mm					
	Connection Thrd.	Outer Pipe Thread (BSP)						
	Total Head	16m (25ft)	27m (89ft)	2700psi	3000psi	3600psi		
	Delivery Volume	130L/min	250L/min	11L/min	15L/min	18L/min		
	Max. Suction Head	8m (26ft)						
	Die Cast Aluminum Body			Ceramic Pistons				
				Brass Pump Body				
ENGINE	Type	Air Cooled 4 Stroke Petrol		Air Cooled 4 Stroke Petrol				
	Model	Honda GX120	Honda GX160	Honda GX160	Honda GX270	Honda GX390		
	Capacity	118cc	163cc	163cc	270cc	389cc		
	Rated Output	2.1kW/3600rpm	3.6kW/3600 rpm	2.9kW/3600 rpm	6kW/3600 rpm	8.6kW/3600 rpm		
	Max. Output	2.9kW/4000rpm	2.9kW/3600 rpm	3.6kW/3600 rpm	6.6kW/3600 rpm	9.6kW/3600 rpm		
	Fuel	Automotive Unleaded Petrol			Automotive Unleaded Petrol			
	Fuel Tank Capacity	2.5 L	3.1 L	3.1 L	6.0 L	6.5 L		
	Cont. Duty	Approx. 2.5 hrs	Approx. 2hrs	Approx. 2.1hrs	Approx. 2.5hrs	Approx. 2.5hrs		
	Starter	Recoil Starter			Recoil Starter			
Gross Weight		38 kg	45 kg	34 kg				
L x W x H (mm)		650 x 410 x 555	700 x 460 x 590	730 x 550 x 540				

COMING SOON



The Koshin Story

Founded in 1948 by the late Mr. Jin-Ichi Kohara, Koshin Ltd is a family business now headed up by Mr. Kohara's son Tsutomu Kohara. President Tsutomu Kohara's own son Aichi Kohara is now also in senior management with Koshin Ltd.

Throughout their sixty years of manufacturing water pumps, Koshin management and staff have focussed on the "Customer First" principle. Their primary policy being to develop products satisfying the needs of users so they can: "offer what is demanded to those who need them".

Koshin has always strived to develop processes that ensure the highest possible standards in all aspects of their operation. For example their quality control is second to none. Even in Japan where systems and quality control are so rigorously maintained Koshin stand out above the crowd. In fact Koshin's Kyoto factory has been appointed by the Kyoto Prefecture as a "Model Instructive Factory" In other words – their factory has achieved such high standards that it is used by other operations as a criterion to strive toward.

Pumpmaster and Davydick are proud to have Koshin as a manufacturing partner. Being part of the Koshin family means that we can all have absolute faith in the product and trust in the people.



WWW.PUMPMASTER.COM.AU